

BRADLEY & MIKEL'S
PEARL
BAR & DINING

Pearl offers many dining options to suit every event need. Accommodations for a small, intimate gathering, large birthday celebration, corporate meetings, a girl's night out and more can all be made possible for you and your guests.

The large semi-private alcove seats up to 30 people and features electronic equipment ideal for PowerPoint or DVD presentations. It's perfect for a large corporate or family event!



The smaller semi-private alcove seats parties up to 10 for more intimate gatherings. Both semi-private alcoves offer sheer or heavy velvet draping depending on your privacy requests.



For a less formal gathering, three semi/private dining areas are available. Choose to sit at a dining table for a small group of up to six, or relax in the lounge with a larger party of up to 12. All three tables feature sheer draping to make your dining experience a little more intimate!

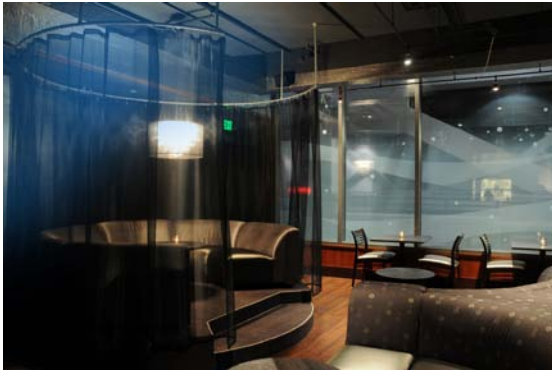

Alcove in the lounge



Alcoves in the Dining Room

For a unique dining experience, sit at the exclusive chef's table. It is the ultimate experience for diners who want an up-close and personal dinner with the accompaniment of Executive Chef and Owner Bradley Dickinson (seats up to eight)!



To make private dining reservations, please contact Pearl Bar & Dining at 425.455.0181.